



NON-LINEAR ANALYSIS OF PLANE STEEL PRESTRESSED TRUSS IN FIRE

Paweł Fedczuk, Wojciech Skowroński¹

Faculty of Civil Engineering, Technical University of Opole, ul. Katowicka 48, 45-061 Opole, Poland.

¹ E-mail: wskow@po.opole.pl

Received 01 June 2001; accepted 05 Febr 2002

Abstract. The concept of analysis of 2-D static loaded prestressed steel trusses till failure during fire using a modified method of forces is presented. Failure of steel trusses in fire is based on the criterion of stresses. Behaviour of steel is described by non-linear constitutive model (based on hypo-elastic Ramberg-Osgood formula and Dorn creep theory) and Plem proposition (for string). Both models are approximated in calculations by hyperbolic Norton-Bailey rule. Fire simulates thermal force as an action of high temperature that increases linearly up to some level. The complete formulation of this method is illustrated by the algorithm of model parameters identification. Analysis of results for specific prestressed truss made of ASTM A36 and A421 steel in fire is presented.

Keywords: fire, steel, truss, creep theory, non-linear constitutive model.

1. Introduction

In various laboratories throughout the world the fire tests of building structures have been made for years. Demand for this research is great and results from the restrictions concerning safety in modern building as well as from the necessity of testing a new, better and cheaper fire prevention for structures, in particular, for the steel ones. Results of fire tests determine the reaction of an element separated from building construction and heated in accordance with a standard.

Fire tests of steel trusses are expensive (cost of fabrication, equipment and maintenance of a testing furnace, cost of manufacture of samples and of experiments) and complicated. That is why some substitute calculating methods are developed. The paper presents the concept of analysis of 2-D static loaded steel truss (with string) till failure during fire by using a modified method of forces [1, 2].

Failure of the steel trusses in fire is based on the criterion of stresses. Behaviour of steel is described by non-linear constitutive model [3] (based on hypo-elastic Ramberg-Osgood formula and Dorn creep theory) and Plem proposition [4] (for string). Both models are approximated in calculations by hyperbolic Norton-Bailey rule. Fire simulates thermal forcing being an action of high temperature that increases linearly up to some level.

The complete formulation of this method contains presentation of calculation algorithm with two-stage method of model parameters identification [5]. Analysis of results for specific prestressed truss made of ASTM A36 and A421 steel in fire is presented.

2. Models of steel

Increase in temperature causes essential changes in the structural steel properties. The proportional limit and the yield stress of steel decrease monotonically with the gain in temperature whereas the strength grows with an increasing temperature up to about 250 °C and then drops rapidly. Cold-drawn steels lose their strength at elevated temperatures faster than mild steel. Elasticity modulus of steel decreases at elevated temperatures but, as it was observed, it decreases slower than the yield stress. At elevated temperatures, steel strains due to creep can be considerable.

Total structural steel strains at elevated temperatures are obtained as a sum of thermal strains and mechanical strains described by the equation of Ramberg-Osgood and time-dependent strains (thermal creep strains) according to Dorn theory [3, 6]:

$$\begin{aligned} \varepsilon_T = \psi(T) = & \varepsilon_T + \sigma \psi_1(T) + \sigma \sigma^{\mu(T)-1} \psi_2(T) \\ & + \sigma \sigma^{m-1} \psi_3(T, t) = \varepsilon_T + \sigma \frac{1}{E(T)} + \sigma \sigma^{\mu(T)-1} \\ & \left[\frac{0.002}{[\sigma_y(T)]^{\mu(T)}} + \sigma \sigma^{m-1} B \left[\int_0^t \exp\left(-\frac{\Delta H}{RT'}\right) dt \right]^3 \right] \end{aligned} \quad (1)$$

ε – denotes strain, σ – stress, ΔH – activation energy of creep, $R = 8,3183$ – gas constant, Joule/moleK, B and m – material constants, t – time, min, T – temperature, °C, T' – temperature, K. Young's modulus $E(T)$, yield stress $\sigma_y(T)$, strain-hardening coefficient $\mu(T)$ and material constants ψ_1 , ψ_2 , ψ_3 – are temperature dependent.

The model was worked out under the following assumptions [7]:

- 1) steel is a homogeneous and isotropic continuum,
- 2) no repeated load is considered,
- 3) the strain process is slow or is a static one,
- 4) strains are small.

Total prestressing steel strain (string) at elevated temperature is obtained as a sum of thermal strains and strains described by the equation of Plem [4]

$$\varepsilon(\sigma, T) = \varepsilon^*_T + \varepsilon_0 \left[2 \sqrt{\frac{Z(\sigma)\theta}{\varepsilon_0}} \right] \text{ for } 0 \leq \theta \leq \theta_0,$$

$$\varepsilon(\sigma, T) = \varepsilon^*_T + \varepsilon_0 \left[1 + \frac{Z(\sigma)\theta}{\varepsilon_0} \right] \text{ for } \theta > \theta_0, \quad (2)$$

where $Z(\sigma)$ is Zener-Hollomon's parameter, ε_0 – stress dependent strain, θ – Dorn's parameter, θ_0 – limit value of Dorn's parameter.

A simplified, but sufficiently accurate for fire engineering purposes, Bailey-Norton formula can replace the equation (1)

$$\varepsilon = A(T, \dot{T}) \sigma^{n(T)} + \varepsilon_T, \quad (3)$$

and (2)

$$\varepsilon = A^*(T, \dot{T}) \sigma^{n^*(T)} + \varepsilon^*_T, \quad (4)$$

where A, n, A^*, n^* denote temperature dependent material functions, $\varepsilon_T, \varepsilon^*_T$ – thermal strains.

3. Identification of the model parameters

3.1. Idea of method

Two stage method of identification [3] is applied for determination of the two pairs of parameters A, n and A^*, n^* from Bailey-Norton equations (3)-(4) that approximates the programmed non-linear constitutive relations (1) and (2). An application of that method requires:

- 1) generation of the set of the pair of value "stress σ_i – strain ε_i " calculated from constitutive equations (1) and (2),
- 2) assessment of the initial values of the parameters A, n and A^*, n^* by the linear least-squares method,
- 3) determination of final values of the parameters A, n and A^*, n^* using gradient method of Marquardt-Levenberg [8, 5, 2].

Details of the method are presented below.

3.2. Generation of data sets

For calculating parameters of Bailey-Norton relation as approximation of constitutive equations (1) and (2) two sets of basic values "stress σ_i – strain ε_i " are computed

for two kinds of steel: ASTM A36 and A421. N values of strains ε_i are calculated from relation (1) or (2) for assumed stress values σ_i (with limitation of computing to proper interval of strains).

Constitutive relation (1) and (2) are demanded completed identification of constants.

Properties of American steel ASTM A36 have been researched in Fire Research Station NRS. Harmathy and Stanzak [4, 6] have published results of tests.

The model (1) coefficients have been calculated by using the least-square method in [1] as characteristics dependent of temperature change T . Values of constants are defined by relations:

- 1) coefficient of linear expansion α [$1/^\circ\text{C}$]
- $$\alpha = a_T T + b_T = 4.8136 \cdot 10^{-9} T + 1.1928 \cdot 10^{-5}, \quad (5)$$

Table 1. Constants a_E and b_E

Interval of temperature T [$^\circ\text{C}$]	a_E [$\text{MPa}/^\circ\text{C}$]	b_E [MPa]
$20^\circ\text{C} < T \leq 200^\circ\text{C}$	-117,72	208 364
$200^\circ\text{C} < T \leq 600^\circ\text{C}$	-274,68	239 756

- 2) modulus of elasticity E [MPa]

$$E = a_E T + b_E, \quad (6)$$

where constants a_E and b_E are given in Table 1,

Table 2. Constants a_μ, b_μ, c_μ and d_μ

Interval of temperature T [$^\circ\text{C}$]	a_μ [$1/^\circ\text{C}$]	b_μ	c_μ [$1/^\circ\text{C}$]	d_μ
$20^\circ\text{C} < T \leq 200^\circ\text{C}$	-0,16489	38,878	0	0
$200^\circ\text{C} < T \leq 591^\circ\text{C}$	-0,02479	21,97	-0,3158	186,65
$591^\circ\text{C} < T \leq 600^\circ\text{C}$	1,5375	-901,32	0	0

- 3) coefficient of amplification μ

$$\mu = a_\mu T + b_\mu - \sqrt{c_\mu T + d_\mu}, \quad (7)$$

with constants a_μ, b_μ, c_μ and d_μ according to Table 2,

Table 3. Constants a_y, b_y and c_y

Interval of temperature T [$^\circ\text{C}$]	a_y [MPa]	b_y [$1/^\circ\text{C}$]	c_y
$20^\circ\text{C} < T \leq 200^\circ\text{C}$	$304,11 \cdot 10^{-3}$	1,33	1026,52
$200^\circ\text{C} < T \leq 600^\circ\text{C}$	$304,11 \cdot 10^{-4}$	9,47	9509,03

- 4) yield point σ_y [MPa]

$$\sigma_y = a_y (b_y T + c_y), \quad (8)$$

where constants a_y, b_y and c_y are given in Table 3.

They have been completed by values of:

- a) coefficient $m = 4,1883$,
- b) quotient of activation energy and gas constant $\Delta H/R = 38900$,
- c) parameter $B = 1,0543 \cdot 10^{-4}$.

The coefficients of model (2) have been calculated using the least-square method as characteristics dependent on temperature change T . Their values are defined by relations:

- 1) coefficient of linear expansion α^* [$1/^\circ\text{C}$]

$$\alpha^* = a^* T + b^* T = 4,8136 \cdot 10^{-9} T + 1,1928 \cdot 10^{-5}, \quad (9)$$

- 2) stress-dependent strain ϵ_σ

$$\epsilon_\sigma = a_{\epsilon_\sigma} \sigma^{b_{\epsilon_\sigma}} = 9,262 \cdot 10^{-5} \sigma^{0,67}, \quad (10)$$

- 3) Zener-Hollomon's parameter $Z(\sigma)$

$$Z(\sigma) = 1,9518 \cdot 10^8 \sigma^3 \quad \text{for } \sigma \leq 172 \text{ MPa}, \quad (11)$$

$$Z(\sigma) = 8,208 \cdot 10^{13} \exp(0,0145 \sigma) \quad \text{for } \sigma > 172 \text{ MPa},$$

- 4) Dorn's parameter θ

$$\theta = \frac{R}{T_m \Delta H} (T + 273,15)^2 \exp \left[\frac{-\Delta H}{R(T + 273,15)} \right], \quad (12)$$

- 5) yield point R_m [MPa]

$$R_m = a_{R_m} (b_{R_m} T + c_{R_m}), \quad (13)$$

where constants a_{R_m} , b_{R_m} and c_{R_m} are shown in Table 4, where quotient of activation energy and gas constant $\Delta H/R = 30\,600$.

Table 4. Constants a_{R_m} , b_{R_m} and c_{R_m}

Interval of temperature T [$^\circ\text{C}$]	a_{R_m} [MPa]	b_{R_m} [$1/^\circ\text{C}$]	c_{R_m}
$20^\circ\text{C} < T \leq 250^\circ\text{C}$	$1,72 \cdot 10^3$	$-5,55550 \cdot 10^{-3}$	1,0111
$250^\circ\text{C} < T \leq 600^\circ\text{C}$	$1,72 \cdot 10^3$	$-2,02857 \cdot 10^{-3}$	1,3671

In calculation the linear increase of temperature T [$^\circ\text{C}$] has been assumed according to formula

$$T = T_m t + T_o, \quad (14)$$

where ratio T_m denotes velocity of temperature change, T_o – initial temperature.

Thermal strains are calculated from formulas

$$\epsilon_T = \alpha T, \quad (15)$$

$$\epsilon^* T = \alpha^* T.$$

3.3. Determination of the initial parameters

Linear least-square method is used to estimate initial values of Bailey-Norton model parameters based upon sets of "stress σ_i – strain ϵ_i " values for selected temperature levels T . The equation (3) can be described as relation

$$\Delta \epsilon_i = \epsilon_i - \epsilon_T = A \sigma_i^n, \quad (16)$$

and can be linearized by two-sided finding the logarithm

$$\ln \Delta \epsilon_i = n \ln \sigma_i + \ln A. \quad (17)$$

Standard proceeding demanded the minimalisation of objective function in form sum of mean square deviations (where $x_i = \ln \sigma_i$ and $y_i = \ln \Delta \epsilon_i$ are independent and dependent variables)

$$Q = \sum_{i=1}^N (n x_i + \ln A - y_i)^2 \quad (18)$$

for N finding the logarithm pairs of values " $\sigma_i - \epsilon_i$ ". Calculation of derivatives $\partial Q / \partial n$, $\partial Q / \partial (\ln A)$ and comparison to zero gives a system of equations which solution yields formulas of parameters A and n :

$$A = \exp \frac{\sum_{i=1}^N x_i^2 \sum_{i=1}^N y_i - \sum_{i=1}^N x_i \sum_{i=1}^N x_i y_i}{N \sum_{i=1}^N x_i^2 - (\sum_{i=1}^N x_i)^2}, \quad (19)$$

$$n = \frac{N \sum_{i=1}^N x_i y_i - \sum_{i=1}^N x_i \sum_{i=1}^N y_i}{N \sum_{i=1}^N x_i^2 - (\sum_{i=1}^N x_i)^2}$$

Identically are defined and calculated parameters A^* , n^* of Bailey-Norton relation as a approximation of constitutive equation (2).

3.4. Determination of the final parameters

Proper estimation of parameters is realized in this stage with using gradient method of Marquardt-Levenberg [8, 5, 2]. This procedure requires iterative solution of matrix equation

$$([A^{*(k)}] + \lambda^{(k)} [I]) \delta^{*(k)} = g^{*(k)}, \quad (20)$$

where $[A^{*(k)}]$ is scaled main matrix obtained as a scaled product of gradient vector $[P]$ for all N data pairs of values (σ_i, ϵ_i) from relations (1) or (2)

$$[A^{*(k)}] = [a_{j j'}^*] = \left[\frac{a_{j j'}}{\sqrt{a_{j j}} \sqrt{a_{j' j'}}} \right],$$

$$[A^{(k)}] = [a_{j j'}] = [P]^T [P], \quad (21)$$

$$[P] = \left[\frac{\partial f_i}{\partial b_j^{(k)}} \right], \quad i = 1, 2, \dots, N; \quad j = j' = 1, 2.$$

Constant f_i is equal to strain ϵ calculated from formula (1) (or (2)) for i independent variable σ_i , but $b_j^{(k)}$ is estimated parameter ($b_j^{(k)} = A$, $b_2^{(k)} = n$ for (1)). Derivates

$\partial f_i / \partial b_j^{(k)}$ are described by formulas

$$\frac{\partial f_i}{\partial b_1^{(k)}} = \sigma_i^n, \tag{22}$$

$$\frac{\partial f_i}{\partial b_2^{(k)}} = A \sigma_i^n \ln(\sigma_i).$$

Matrix $\mathbf{g}^{*(k)}$ defines relations

$$\mathbf{g}^{*(k)} = [\mathbf{g}^*] = \left[\frac{g_j}{\sqrt{a_{jj}}} \right], \tag{23}$$

$$\mathbf{g}^{(k)} = [\mathbf{g}_j] = [\mathbf{P}]^T (\boldsymbol{\varepsilon} - \mathbf{f}),$$

where $\boldsymbol{\varepsilon}$, \mathbf{f} are vectors consisting of values ε_i and strains calculated from formula (3) (or (4)) for variables σ_i . Scaled vector of correction $\boldsymbol{\delta}^{*(k)}$ is determined from transformed equation (21)

$$\boldsymbol{\delta}^{*(k)} = ([\mathbf{A}^{*(k)}] + \lambda^{(k)}[\mathbf{I}])^{-1} \mathbf{g}^{*(k)}, \tag{24}$$

where constant $\lambda^{(k)}$ multiplied by identity matrix \mathbf{I} modifies diagonal of matrix $[\mathbf{A}^{*(k)}]$.

Algorithm of Marquardt-Levenberg procedure requires „step by step” realization of calculations contained:

- 1) computation objective function $Q(\lambda^{(k-1)=0}) = 10^{-2}$, $\mathbf{b}^{(k-1)=0}$ for initial values of parameter $\mathbf{b}^{(k-1)=0}$,
- 2) determination of gradient vector $[\mathbf{P}]$ and scaled main matrix $[\mathbf{A}^{*(k)}]$ from formulas (21),
- 3) calculation of scaled vector $\mathbf{g}^{*(k)}$ from relations (23),
- 4) computation scaled vector of correction $\boldsymbol{\delta}^{*(k)}$ from (20) and normal ones $\boldsymbol{\delta}^{(k)}$ described by formula

$$\boldsymbol{\delta}^{(k)} = [\boldsymbol{\delta}_j] = \left[\frac{\delta_j^*}{\sqrt{a_{jj}}} \right], \tag{25}$$

- 5) actualization of parameter vector $\mathbf{b}^{(k)}$

$$\mathbf{b}^{(k)} = \mathbf{b}^{(k-1)} + \boldsymbol{\delta}^{(k)}, \tag{26}$$

- 6) computation objective function $Q(\lambda^{(k)}, \mathbf{b}^{(k)})$,
- 7) check the finish of calculation condition

$$\frac{\delta_j^*}{\tau + b_j} \leq \beta, \tag{27}$$

where constants $\tau = 10^{-3}$, $\beta = 10^{-5}$ and continuation computation for $(k=k+1)$ from point (2) (in case of no satisfy this condition).

Calculation steps (5) - (6) are realized for two constants $\lambda^{(k-1)}$ and $\lambda^{(k-1)}/10$ which give two objective functions $Q(\lambda^{(k-1)}, \mathbf{b}^{(k)})$ and $Q(\lambda^{(k-1)}/10, \mathbf{b}^{(k)})$. Depending on relation between these functions new value of $\lambda^{(k)}$ for iteration step (k) is determined as equal:

- a) $\lambda^{(k)} = \lambda^{(k-1)}$ when $Q(\lambda^{(k-1)}, \mathbf{b}^{(k)}) \leq Q(\lambda^{(k-1)}/10, \mathbf{b}^{(k)})$,
- b) $\lambda^{(k)} = \lambda^{(k-1)}/10$ when $Q(\lambda^{(k-1)}/10, \mathbf{b}^{(k)}) < Q(\lambda^{(k-1)}, \mathbf{b}^{(k)})$ and $Q(\lambda^{(k-1)}/10, \mathbf{b}^{(k)}) \leq Q(\lambda^{(k-1)}, \mathbf{b}^{(k-1)})$,

- c) $\lambda^{(k)} = 10^\xi \lambda^{(k-1)}$ when $Q(\lambda^{(k-1)}/10, \mathbf{b}^{(k-1)}) > Q(\lambda^{(k-1)}, \mathbf{b}^{(k-1)})$ and $Q(\lambda^{(k-1)}/10, \mathbf{b}^{(k)}) > Q(\lambda^{(k-1)}, \mathbf{b}^{(k)})$

(with $\xi = 1, 2, \dots, \xi_{max}$ repetition until satisfying a condition).

This algorithm is used twice – first, for calculation pair of values A , n and second – for specification A^* , n^* (approximation of parameters for two different constitutive equations (1) and (2)).

4. Modified method of forces

4.1. Idea of method

For an analysis of the statically indeterminate space steel trusses, the modified method of forces [1, 2] is applied. The method considers approximation by equations (3)-(4) of non-linear constitutive relation (1) and (2) for steel. It is assumed that:

- 1) truss consists of steel bars (connected jointly in nodes) treated as one-dimensional elements,
- 2) fire simulates thermal forcing being, generally, an action of the temperature that increases linearly up to some level under an assumed rate of increment, individually, for a particular truss member,
- 3) static load in a form of the system of forces is applied to the joints,
- 4) all system and its particular components (struts) do not loose stability at elevated temperatures,
- 5) failure of the system occurs in case of exceeding a mean value of stress (in a section of any bar) that is limited by a yield stress at elevated temperatures,
- 6) prestress of string is simulated by assembly error which size is equal to shortening of string prestressed to stress level $\sigma = 0,8 R_m(T=20^\circ\text{C})$,

Analysis of such defined problem by modified method of forces requires solution of the system of an algebraic non-linear equation:

$$\mathbf{F}(\mathbf{X}^{(j)}) = \mathbf{0}, \tag{28}$$

where components of the vector of function $\mathbf{F}(\mathbf{X}^{(j)})$ have a form

$$F_i(X_i) = \sum_s \frac{\{ \sum_{k=1}^K [Z_s(X_k) \cdot X_k] + Z_s(P) \}^{n_s} \cdot Z_s(X_i)}{(A_s)^{-1} \cdot f_s^{n_s} \cdot l_s + \delta_{iT} + \delta_{i\Delta}}, \tag{29}$$

$$\delta_{iT} = \sum_s [Z_s(X_i) \varepsilon_T l_s],$$

$$\delta_{i\Delta} = - \sum_s [Z_s(X_i) \Delta l_s].$$

The system of such equations is created routinely, by reduction of indeterminate truss system to determined one by means of selection of K redundant forces X_i and

establishing forces $Z_s(X_i)$ and $Z_s(P)$ in bars for states $X_i=1$ and for external load P . Coefficients δ_{iT} are displacements along the direction of redundant X_i induced by changes in temperatures T . Coefficients $\delta_{i\Delta}$ are displacements induced by assembly errors (shortenings of strings Δl_s prestressed to stress level $\sigma = 0,8 R_m(T=20^\circ\text{C})$). Length l_s and area of section f_s characterize geometry of a bar or string. Constants A_s, n_s and thermal deformation ϵ_T define steel on every of the considered level of temperature T under the rate of their increment.

4.2. Algorithm of method

Solution is achieved by calculation of an algorithm that requires:

- I) identification of the parameters of Bailey-Norton model by two-stages method,
- II) solution of the system of equation (28) in question using iteration Newton method by:
 - a) assignment of the forces Z_s in truss bars for states $X_i=1$ and for external load P and assessment of the initial values of the vector components redundant $\mathbf{X}^{(j)}$,

- b) calculation of the vector of function $\mathbf{F}(\mathbf{X}^{(j)})$ from relation (29) and matrix of derivatives $\mathbf{F}'(\mathbf{X}^{(j)})$ by means of finite difference method,
- c) corrections of the redundant values according to the formula:

$$\mathbf{X}^{(j+1)} = [\mathbf{F}(\mathbf{X}^{(j)})]^{-1} \mathbf{F}(\mathbf{X}^{(j)}), \quad (30)$$

- d) checking of the condition of calculation interruption for all components of vector $\mathbf{F}(\mathbf{X}^{(j)})$ (and in case of not satisfying the above condition – continuation of iteration from point (b))

$$F_i(X_i^{(j)}) \leq \tau \quad (\tau = 10^{-4}), \quad (31)$$

- e) assignment of the real values of forces Z_s in truss bars for determined vector $\mathbf{F}(\mathbf{X}^{(j)})$,

- III) checking of the failure condition of the truss structure according to the criterion of stresses

$$-\sigma_y(T) \leq \sigma = \frac{Z_s}{f_s} \leq \sigma_y(T), \quad (32)$$

$$-R_m(T) \leq \sigma = \frac{Z_s}{f_s} \leq R_m(T).$$

5. Set of computer programs

Described algorithm is used by application made of a set of three integrated computer programs (Fig 1) that communicate by a common database.

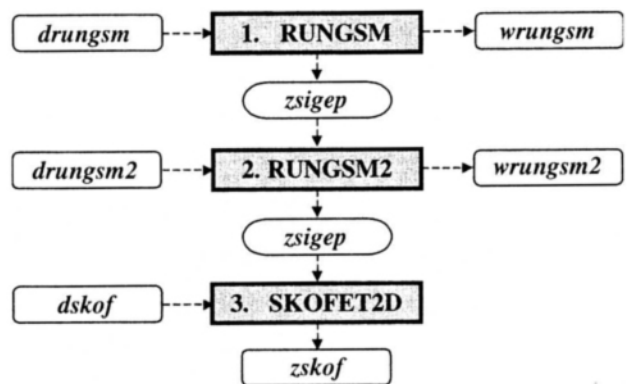

Fig 1. Structure of computer program set

All programs have been written in the FORTRAN 88 using double precision numbers in the calculation. The program RUNGSM realized identification parameters of Bailey-Norton formula (3) for steel ASTM A36. The calculation results are located in output data set *zsigep* (in form complete of 4 values: A, n, ϵ_T and σ_y). The second program RUNGSM2 realized specification parameters of Bailey-Norton equation (4) for steel ASTM A421. The calculation results are located in the same output data set *zsigep* (in form complete of 4 values: A^*, n^*, ϵ^*_T and R_m). Calculation according to presented algorithm of modified method of force is realised by the third program SKOFET2D, which final results located in output data *wskof*. Set *drungsm, drungsm2* and *dskof* are input data for these programs, but *wrungsm, wrungsm2* are output data (illustrating details of calculation).

6. Numerical example

One-time statically internally indeterminate system of plane prestressed steel truss (Fig 2) made of steel ASTM A36 and ASTM A421 (for string) was exposed to calculation analysis of thermal influences. All bars were made of pair angle bars. Areas of all horizontal bars and cross braces K_1 and symmetric equal to $f_s = 69,6 \cdot 10^{-4} \text{ m}^2$.

Areas of the other cross braces and truss posts are equal $f_s = 45,4 \cdot 10^{-4} \text{ m}^2$. Area of string (7 stranded wires) equals to $f_s = 2,88901 \cdot 10^{-4} \text{ m}^2$. This string was prestressed to stress level $\sigma = 0,8\sigma_y(T=20^\circ\text{C}) = 1,71998 \cdot 10^6 \text{ kPa}$.

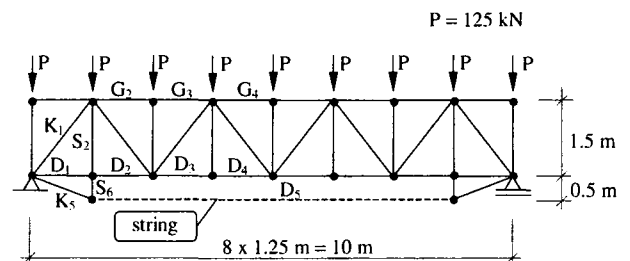

Fig 2. Plane prestressed steel truss

Upper joints of the structure are loaded by a set of 9 vertical concentrated forces $P = 125 \text{ kN}$. Action of

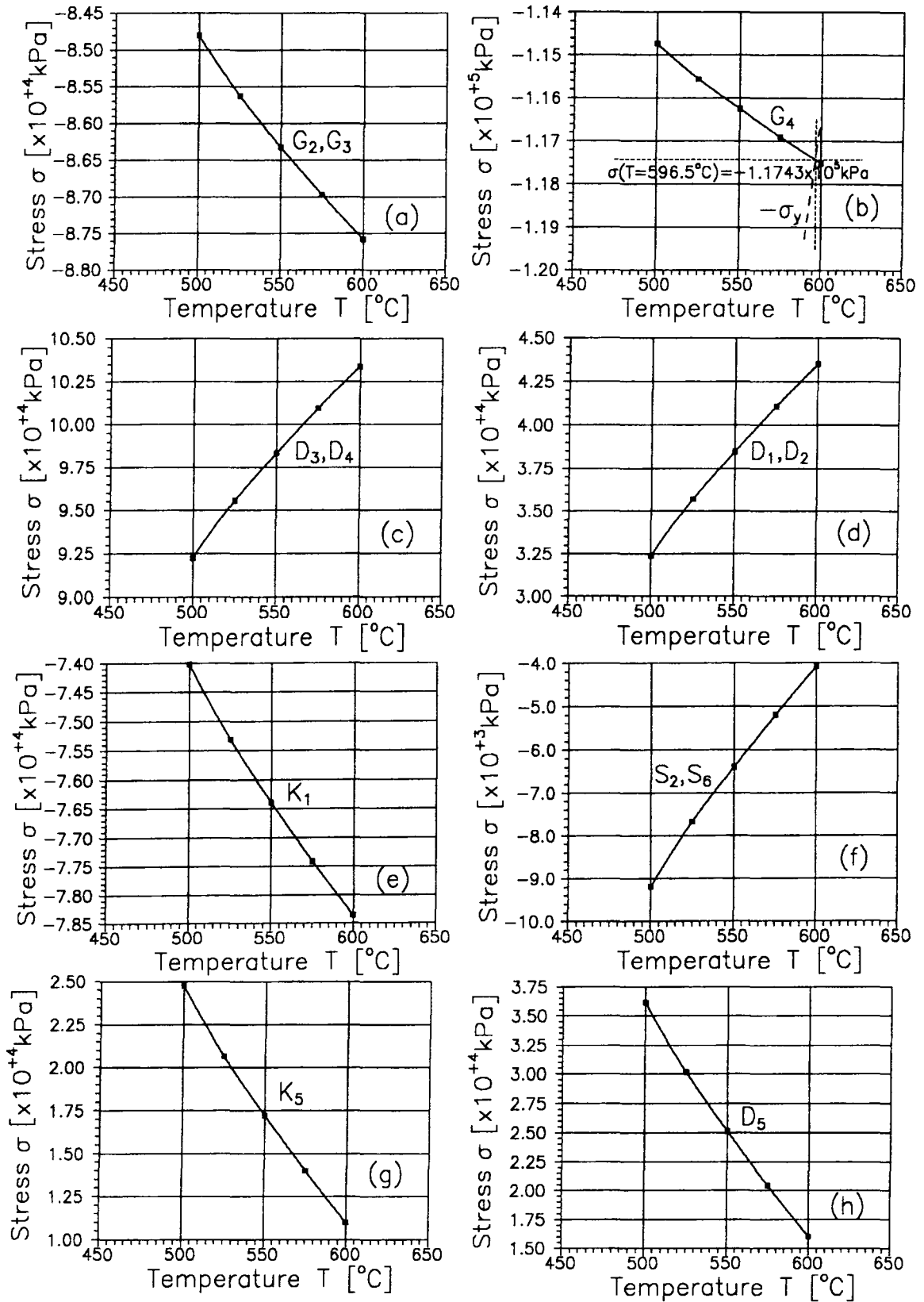

Fig 3. Distribution of stresses in chosen bars

fire is simulated using rate of temperature change equal to 8 °C/min. Calculation was performed for 5 levels of temperatures T (500 °C, 525 °C, 550 °C, 575 °C and 600 °C).

Table 5. Parameters $A, n, \epsilon_T, \sigma_T(T)$ for steel ASTM A36

Temperature T [°C]	A [1/kPa]	n	ϵ_T [10^{-3}]	$\sigma_T(T)$ [10^5 kPa]
500	$2,06512 \cdot 10^{-21}$	3,26917	7,16740	1,45183
525	$1,90019 \cdot 10^{-21}$	3,67152	7,58895	1,37983
550	$1,76798 \cdot 10^{-21}$	3,71260	8,01651	1,30783
575	$1,66561 \cdot 10^{-21}$	3,75187	8,45010	1,23584
600	$1,70651 \cdot 10^{-21}$	3,77900	8,88970	1,16384

Proper computation has been preceded by parameter identification of Bailey-Norton formula using two-stage method. Calculation was performed by means of two programs RUNGSM and RUNGSM2 for 5 levels of temperatures T . Results of specification for both kinds of steel are presented in Tables 5, 6.

The results of proper calculation for a chosen bars marked as in Fig 2 are presented in Fig 3 in a form characteristics "stress σ – temperature T ". Calculation was performed by means of program SKOFET2D (according to algorithm modified method of forces) for 5 levels of temperatures T .

Failure of the truss with a string occurs as a result of exceeding, in bars G_4 and symmetric, the criterion of stresses (33) at temperature $T = 596,5$ °C.

Table 6. Parameters $A^*, n^*, \epsilon^*_T, R_m(T)$ for steel ASTM A421

Temperature T [°C]	A^* [1/kPa]	n^*	ϵ^*_T [10^{-3}]	$R_m(T)$ [10^5 kPa]
500	$1,26357 \cdot 10^{-20}$	3,21662	7,16740	1,45183
525	$1,70130 \cdot 10^{-17}$	2,70682	7,58895	1,37983
550	$3,30071 \cdot 10^{-14}$	2,34237	8,01651	1,30783
575	$2,15005 \cdot 10^{-14}$	2,25270	8,45010	1,23584
600	$5,84826 \cdot 10^{-15}$	2,43132	8,88970	1,16384

6. Conclusions

The analysis performed indicates that it is possible to calculate precisely the fire resistance of steel trusses on the basis of:

- (1) the known properties of steel at elevated temperature,
- (2) the details of a cross-section dimensions, loaded shape of a construction,
- (3) the data concerning the temperature increase in a construction, determined by the efficiency of the fire-proof insulation.

The problem is important for people's safety.

References

1. Fedczuk P., Skowroński W. Effects of fire temperature changes on the flat steel truss. *Scientific Collection (Zeszyty Naukowe)*, Vol 41, No 224/96, Opole: Technical University, 1996, p 109-121 (in Polish).
2. Fedczuk P., Skowroński W. Fire study of steel trusses in interacting systems of tall buildings. In: *Proceedings of 5th International Conference on Tall Buildings*, Vol 1, Hong Kong, 1998, p 1712-1732.
3. Skowroński W. Load capacity and creep problems of structural steelworks in fire. Study and Monography Z. 62, Opole: Technical University, 1992 (in Polish).
4. Plem E. Theoretical and experimental investigations of point set structures. Document D9, Stockholm: Swedish Council for Building Research, 1975.
5. Fedczuk P., Skowroński W. Two-stages method of parameter identification of Bailey-Norton model for fire heated structural steel. In: *Scientific Collection (Zeszyty Naukowe)*, Vol 40, No 222/96, Opole: Technical University, 1996, p 51-67 (in Polish).
6. Skowroński W. Buckling fire endurance of steel columns. *Journal of Structural Engineering*, Vol 119, No 6, 1993, p 1712-1732.
7. Skowroński W. Material characteristics in the analysis of heated steel beams. *Fire and Materials*, Vol 14, No 3, 1989, p 107-116.
8. Marquardt D. W. An algorithm for least squares estimation of nonlinear parameters. *J. Soc. Industr. Appl. Math*, Vol 11, No 2, 1963, p 431-441.